

MONTERINGSVEJLEDNING LINAK MOTOR

INSTALLATION INSTRUCTIONS LINAK MOTOR

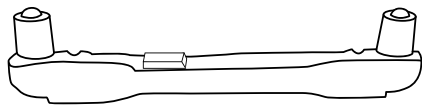

x 1 Motor (M)

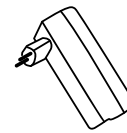

x 1 Adapter (A)



x 1 Fjernbetjening (F)

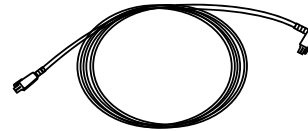

x 1 Kabel (K)



1

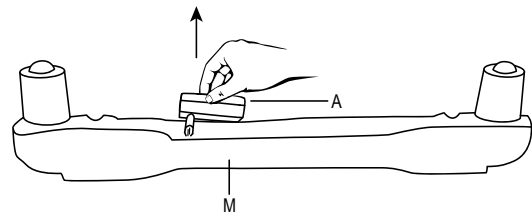

2

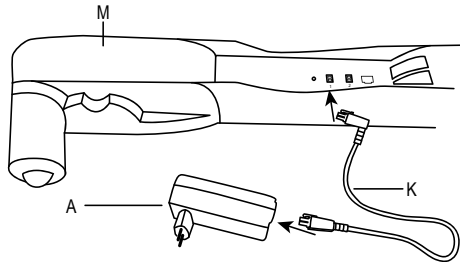

3

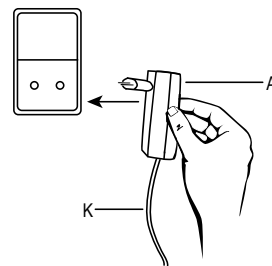

4

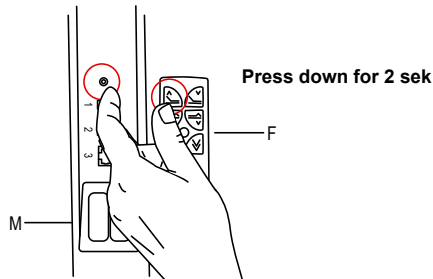

5

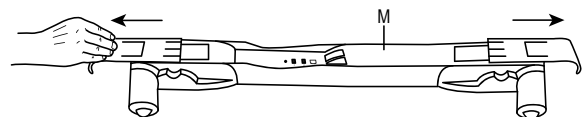

6

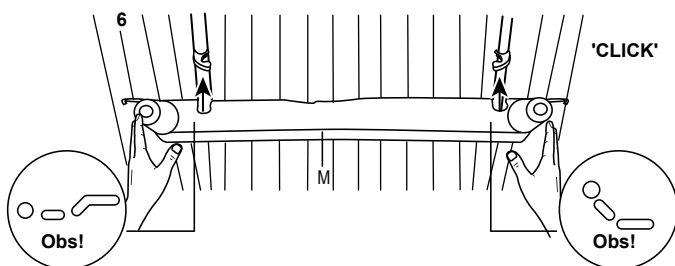

7

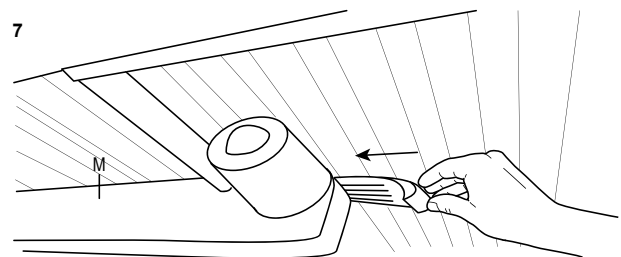

DK - Garantien bortfalder, hvis man sidder, hopper eller på anden måde u hensigtsmæssigt belaster hoved- og fodenden, når disse er eleveret/hævet op!

SE - Garantin gäller inte, om man sitter, hoppar eller på annat vis missbukar sängen, när huvud- och eller fotänden är elverad!

UK - The warranty expires if you sit, jump or otherwise inappropriate overload the head- and foot section when these are elevated/raised!



www.europeanhouseofbeds.com/faq/

european house of beds [®]
designing future bed culture